

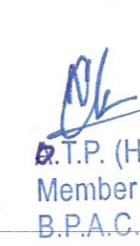





This is a "PROVISIONAL BUILDING PLAN" approved only for the purpose of inviting objections from the general public

 S.T.P. (Hq) Member B.P.A.C.
 S.T.P. (Hq) Member Secretary B.P.A.C.
 S.T.P. (G) Member B.P.A.C.
 S.T.P. (Hr.) Chairman B.P.A.C.

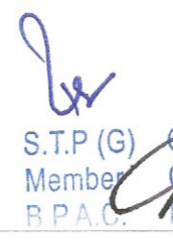
 AD
 PA
 ATP
 Consultant Architect
 ATP (HQ)
 (Dinesh Kumar) PA (HQ)

DN (T) MEMBER BPAC

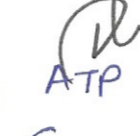
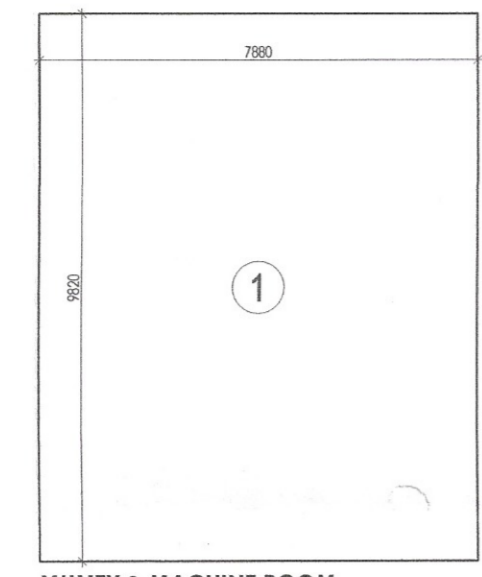

MUMTY & MACHINE ROOM AREA DIAGRAM

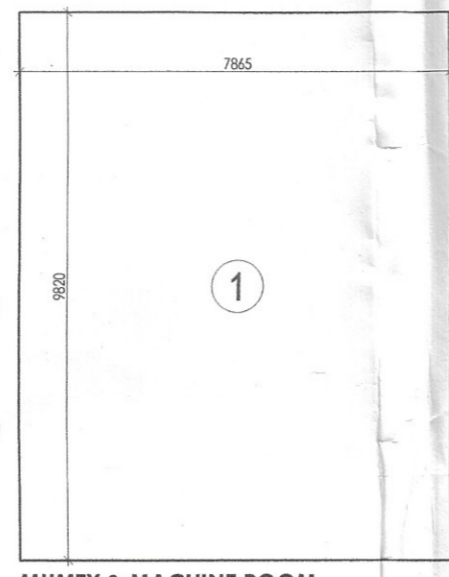

MUMTY & MACHINE ROOM AREA DIAGRAM

PLUMBING LEGEND		LEGEND:-	
SYMBOL	DESCRIPTION	SYMBOL	DESCRIPTION
①	1100 OD uPVC SP STACK	—	SOIL PIPE
②	1100 OD uPVC WP STACK	—	WASTE PIPE
③	750 A.S.P	—	FLOOR TRAP
④	DWS D/TAKE	—	CUTOUT
⑤	FWS D/TAKE	—	FLOOR DRAIN
⑥	DWS RISER	—	CWS PIPE
⑦	FLUSHING RISER	—	FWS PIPE
⑧	1100 OD uPVC R.W.P	—	CONTROL VALVE
⑨	750 uPVC DRAIN PIPE(BALCONY)	—	FIRE PIPE

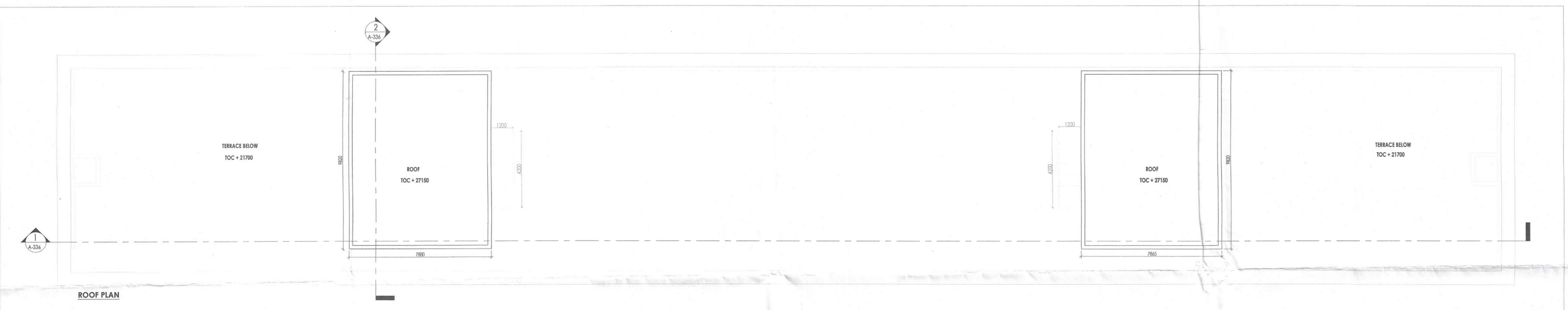

ROOF PLAN

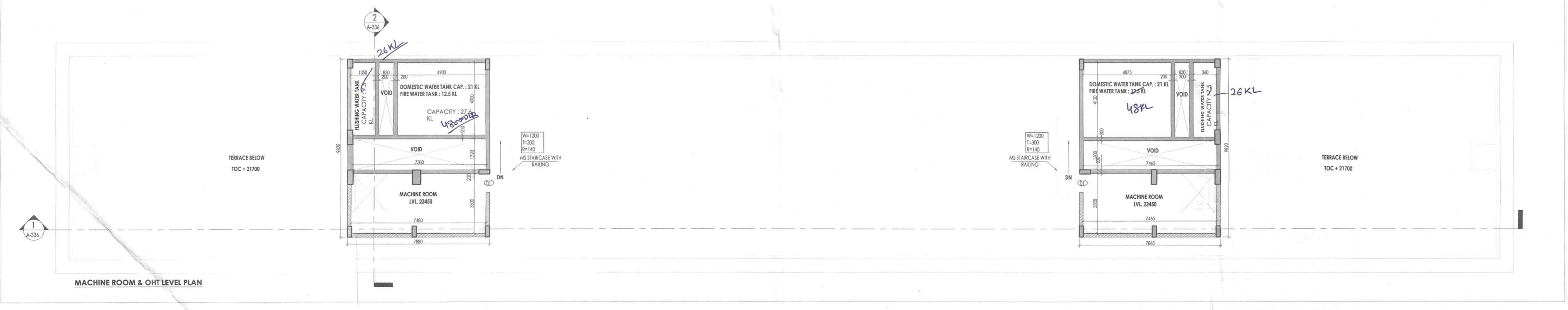

MACHINE ROOM & OHT LEVEL PLAN

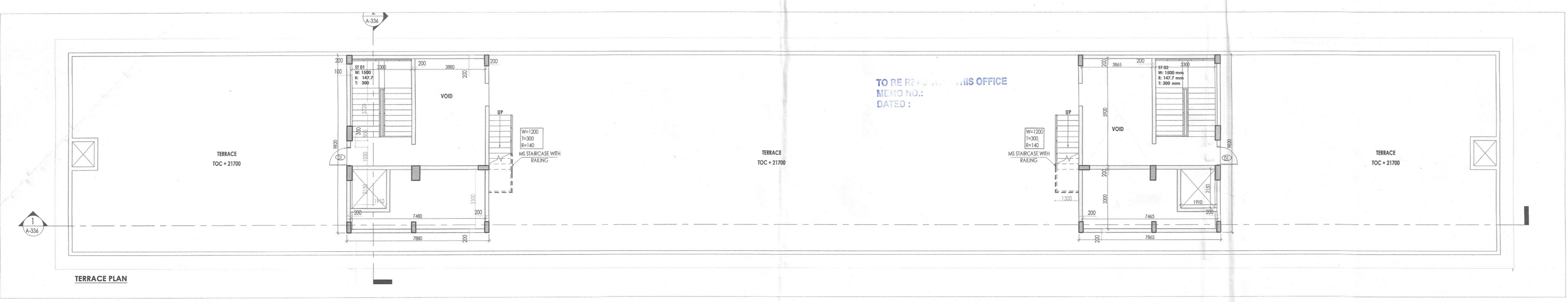

TERRACE PLAN

TO BE RECHECKED IN THIS OFFICE
MEMO NO.:
DATED :

Door Schedule

Type	Mark	Width	Height
—	D1	1460	2100
—	D2	1050	2100
—	D3	900	2100
—	D4	750	2100
—	D5	1800	2400
—	D6	750	1800
—	D7	1200	2100
—	D8	1550	2100
—	D9	750	2100
—	D10	1200	2100
—	D11	900	2100

Window Schedule

Type	Mark	Width	Height
—	W1	1500	1300
—	W2	600	900

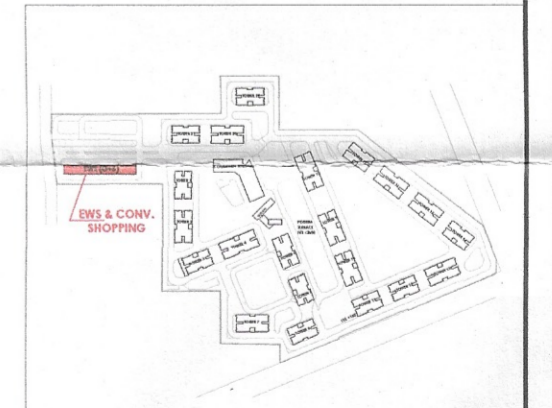

Checked and found ok for Public Health (Internal) Service only subject to comments in forwarding letter No. DV

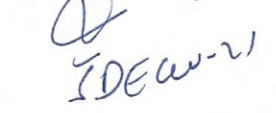
Superintending Engineer (HQ)
 for Chief Engineer-I
 HSPV, Puzosula
 IDEAW

PROJECT: Revised Building Plans of Group Housing Colony measuring 22.344 Acres (License No. 41 of 2010 Dated 07.06.2010) in sector-93, Gurugram being developed by Ashiana Housing Ltd. comprising of total of Five (5) phases.

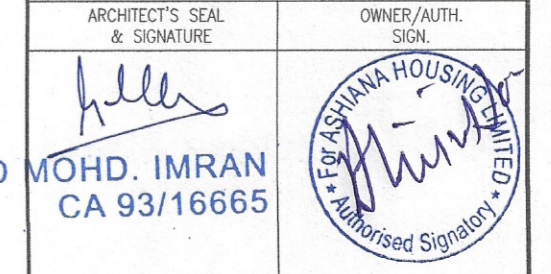
ARCHITECT'S SEAL & SIGNATURE: 

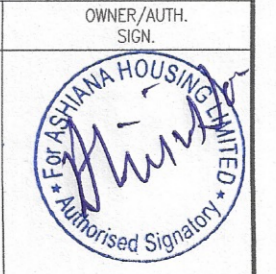
OWNER/AUTHOR: 

Scale: 1 : 100

Drawing Title: TERRACE, MUMTY MACHINE ROOM, OHT PLAN & AREA DETAILS (EWS & CONV. SHOPPING)

Drawing No.: A-52