

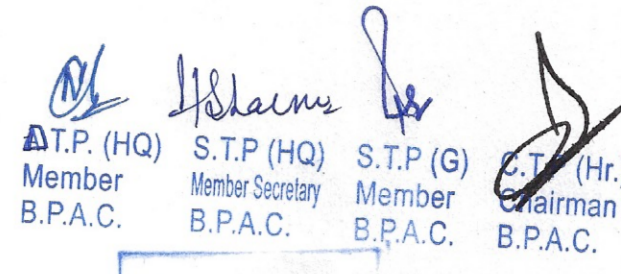
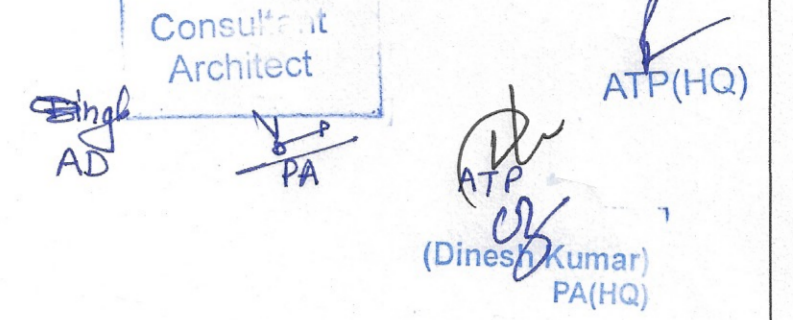

This is a 'PROVISIONAL BUILDING PLAN' approved only for the purpose of inviting objections from the general public

 D.T.P. (HQ) Member B.P.A.C. S.T.P. (HQ) Member Secretary B.P.A.C. S.T.P. (G) Member B.P.A.C. (Hr.) Chairman B.P.A.C.

Consultant Architect

 AD PA (Dinesh Kumar) PA(HQ) ATP(HQ)

Checked and found ok for Public Health (Internal) Service only subject to comments in forwarding letter No.D/V.....

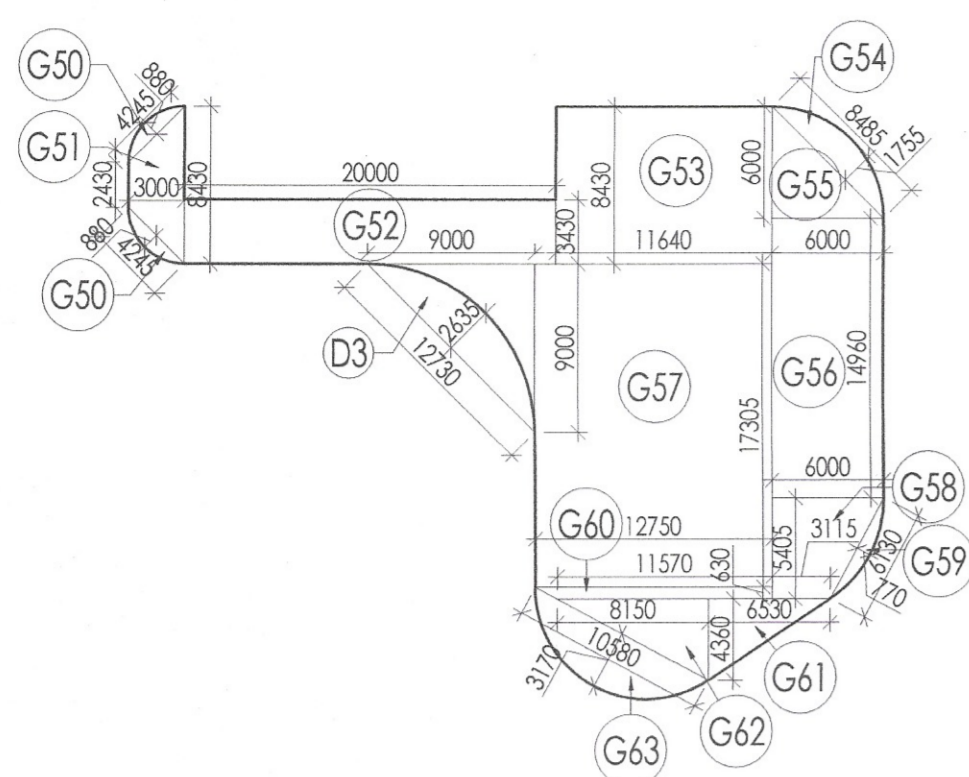
Supervising Engineer (HQ) for Chief Engineer, HSPV, Panipat

 SDEw-1

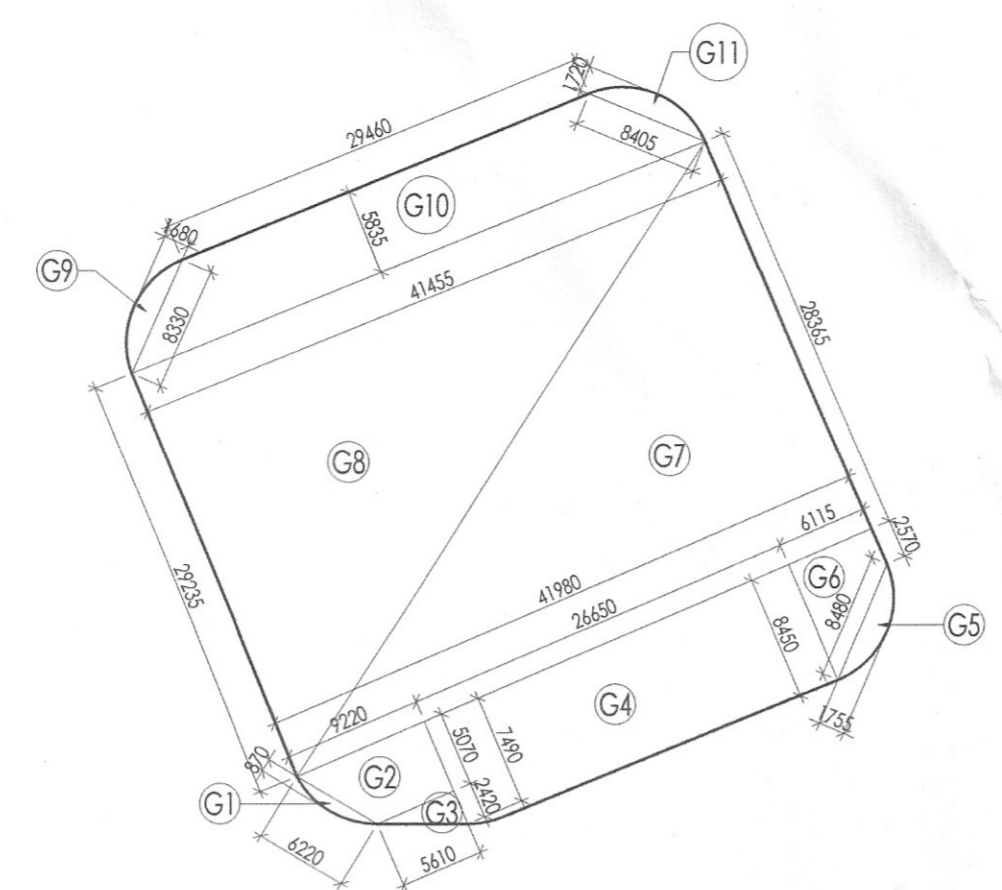

LANDSCAPE GREEN-5



LANDSCAPE GREEN-2

GREEN AREA CALCULATIONS				
S.NO.	COFF.	CALCULATIONS	NO.	AREA IN SQMT.
ADDITIONS				
G1	0.667	6.220	0.870	3.609
G2	(5.61+9.22)/2	5.070	1	37.594
G3	0.5	5.610	2.420	6.788
G4	(7.49+8.45)/2	26.650	1	212.401
G5	0.667	8.480	1.755	9.927
G6	(2.57+8.45)/2	6.115	1	33.694
G7	0.5	41.980	28.365	595.381
G8	0.5	41.455	29.235	605.968
G9	0.667	8.330	1.680	9.334
G10	(41.455+29.46)/2	5.835	1	206.895
G11	0.667	8.405	1.760	9.867
G12	0.667	8.490	1.760	9.967
G13	(9.225+21.225)/2	6.010	1	91.502
G14	0.667	8.490	1.720	9.740
G15	0.5	21.225	93.975	997.310
G16	0.5	21.105	93.975	991.671
G17	(21.105+22.285)/2	5.505	1	119.431
G18	0.5	22.285	20.665	230.260
G19	0.5	22.230	20.680	229.858
G20	0.667	8.475	1.750	9.892
G21	(22.23+10.23)/2	6.000	1	97.380
G22	0.5	8.485	1.755	7.446
G23	0.5	34.445	27.030	465.524
G24	0.5	116.555	40.315	2349.457
G25	0.5	44.375	98.375	2182.695
G26	0.5	50.310	98.375	2474.623
G27	0.667	10.390	3.000	20.790
G28	0.5	8.785	5.545	24.356
G29	(6.235+8.785)/2	83.325	1	625.771
G30	0.5	5.810	6.235	18.113
G31	0.667	8.525	1.810	10.292

G32	0.667	8.485	1.755	1	9.932
G33	(13.28+1.475)/2	6.020	1	44.413	
G34	0.667	8.350	1.690	1	9.412
G35	1	12.490	13.280	1	165.867
G36	(16.65+10.650)/2	5.995	1	81.832	
G37	0.667	7.815	1.395	1	7.272
G38	(16.255+7.29)/2	9.000	1	105.953	
G39	(7.635+7.65)/2	27.625	1	211.124	
G39a	(9.965+7.635)/2	6.070	1	53.416	
G40	(28.955+9.965)/2	26.250	1	510.825	
G41	0.5	28.955	30.425	1	440.478
G42	0.5	38.330	17.170	1	329.063
G43	(8.025+17.17)/2	11.400	1	143.612	
G44	0.667	10.475	2.195	1	15.336
G45	(5.285+10.185)/2	9.350	1	72.322	
G46	(3.355+9.35)/2	6.110	1	38.814	
G47	0.667	8.565	1.795	1	10.255
G48	(44.175+49.73)/2	8.275	1	388.532	
G49	0.667	9.965	2.655	1	17.647
G50	0.667	4.245	0.880	2	4.983
G51	(2.430+8.430)/2	3.000	1	16.290	
G52	1	20.000	3.430	1	68.600
G53	1	11.640	8.430	1	98.125
G54	0.667	8.485	1.755	1	9.932
G55	0.5	6.000	6.000	1	18.000
G56	1	14.960	6.000	1	89.760
G57	1	12.750	17.305	1	220.639
G58	(3.115+6.000)/2	5.405	1	24.633	
G59	0.667	6.130	0.770	1	3.148
G60	(11.570+12.750)/2	0.630	1	7.660	
G61	0.5	6.530	4.360	1	14.235
G62	0.5	8.150	4.360	1	17.767
G63	0.667	10.580	3.170	1	22.370
TOTAL ADDITIONS (A) = 15969.784					
DEDUCTIONS					
D1	0.667	12.705	2.625	1	22.245
D2	0.667	14.165	2.480	1	23.431
D3	0.667	12.730	2.635	1	22.374
TOTAL DEDUCTIONS (B) = 68.050					
NET GREEN AREA (A - B) = 15901.734					

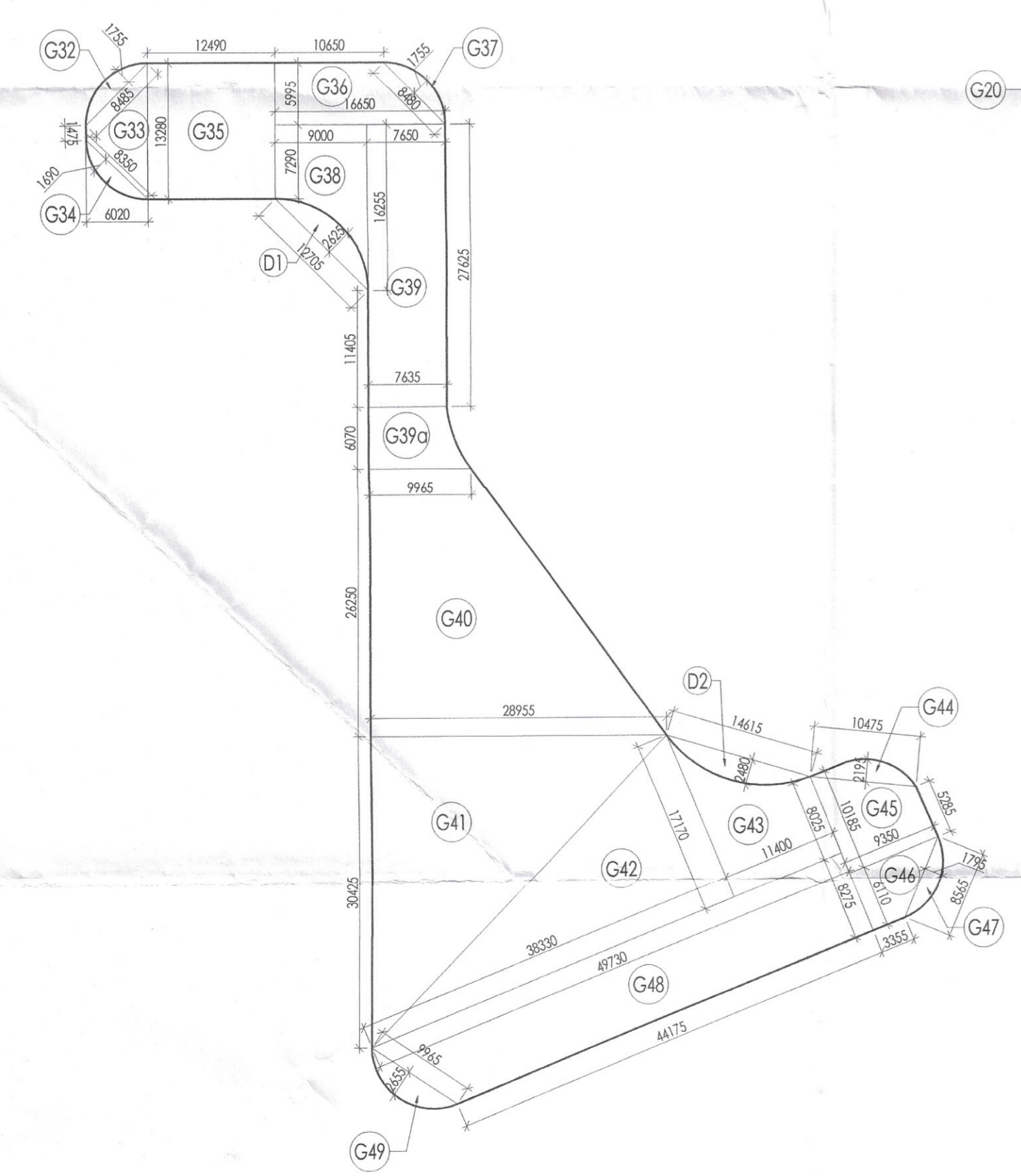

LANDSCAPE GREEN-1

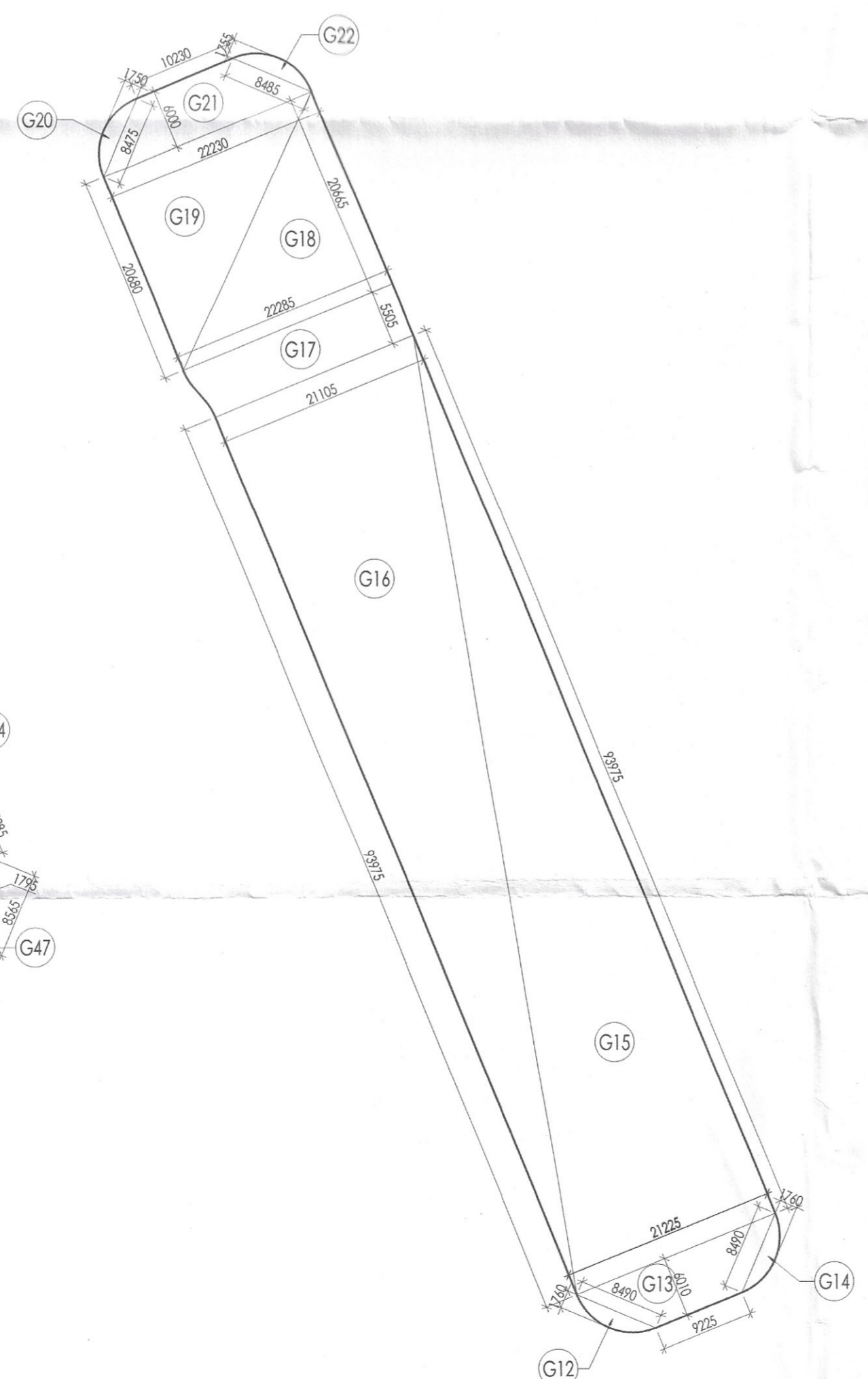

LANDSCAPE GREEN-3

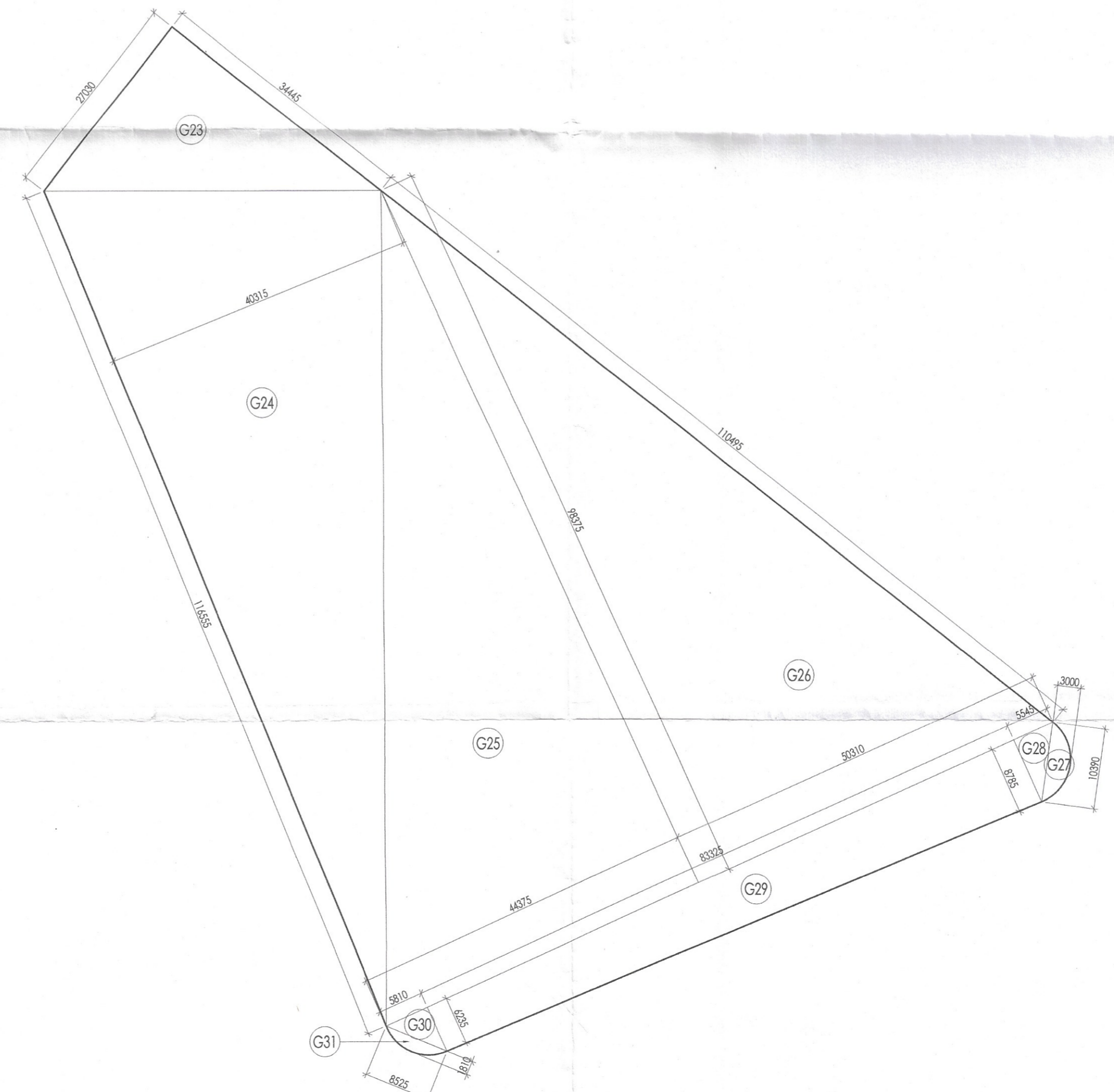

LANDSCAPE GREEN-4

PROJECT
Revised Building Plans of Group Housing Colony measuring 22.344 Acres (License No. 41 of 2010 Dated 07.06.2010) in sector-93, Gurugram being developed by Ashiana Housing Ltd. comprising of total of Five (5) phases

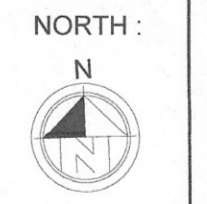

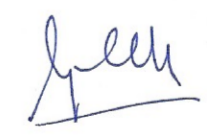
ARCHITECT'S SEAL & SIGNATURE
 SYED MOHD. IMRAN
 CA 93 (16665)

OWNER/AUTH. SIGN.

 ASHIANA HOUSING LTD.
 Member Secretary B.P.A.C.

TO BE READ WITH THIS OFFICE MEMO NO. DATED :

Scale : **1 : 500**
 Drawing Title:- **GREEN AREA CALCULATIONS**
 Drawing No:- **A-01.3**